

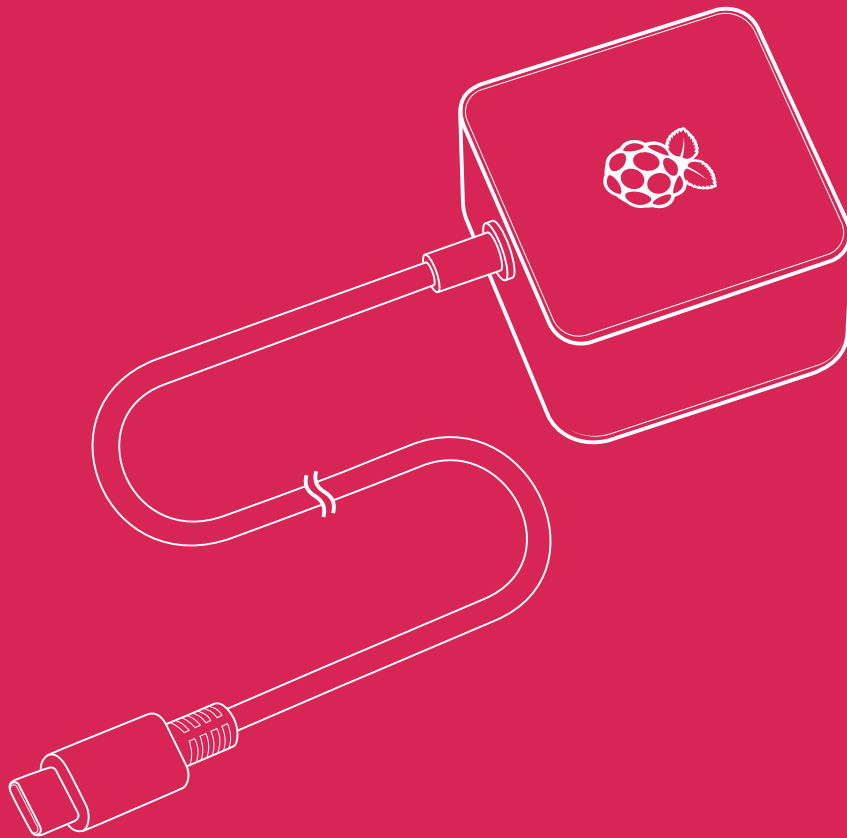

# Raspberry Pi 15W USB-C Power Supply

Published November 2021



## Overview



The official Raspberry Pi USB-C Power Supply is designed to power Raspberry Pi 4 Model B and Raspberry Pi 400 computers.

Featuring a captive USB-C cable, the power supply is available in five different models to suit different international power sockets, and in two colours, white and black.

## Specification

### Output

|                       |   |
|-----------------------|---|
| Output voltage:       | +5.1V DC  |
| Minimum load current: | 0.0A  |
| Nominal load current: | 3.0A  |
| Maximum power:        | 15.0W   |
| Load regulation:      | ±5%   |
| Line regulation:      | ±2%   |
| Ripple & noise:       | 120mVp-p  |
| Rise time:            | 100ms maximum to regulation limits for DC outputs                                 |
| Turn-on delay:        | 3000ms maximum at nominal input AC voltage and full load                          |
| Protection:           | Short circuit protection<br>Overcurrent protection<br>Over temperature protection |
| Efficiency:           | 81% minimum (output current from 100%, 75%, 50%, 25%)                             |
| Output cable:         | 1.5m 18AWG  |
| Output connector:     | USB Type-C  |

### Input

|                              |   |
|------------------------------|---|
| Voltage range:               | 100–240Vac (rated)<br>96–264Vac (operating)             |
| Frequency:                   | 50/60Hz ±3Hz  |
| Current:                     | 0.5A maximum  |
| Power consumption (no load): | 0.075W maximum  |
| Inrush current:              | No damage shall occur and the input fuse shall not blow |

## Plug styles

| Part number      | Product number | Colour | Plug Style  | Plug Type      |
|------------------|----------------|--------|-------------|----------------|
| KSA-15E-051300HU | SC0445         | White  | US          | Type A         |
|                  | SC0218         | Black  |             |                |
| KSA-15E-051300HE | SC0444         | White  | Europe      | Type C         |
|                  | SC0217         | Black  |             |                |
| KSA-15E-051300HK | SC0443         | White  | UK          | Type G         |
|                  | SC0216         | Black  |             |                |
| KSA-15E-051300HA | SC0523         | White  | Australia   | Type I         |
|                  | SC0219         | Black  | New Zealand |                |
|                  |                |        | China       |                |
| KSA-15E-051300HI | SC0478         | White  | India       | Type D (2-pin) |
|                  | SC0479         | Black  |             |                |

## Environment

Operating ambient temperature 0–40°C

## Compliance

For a full list of local and regional product approvals, please visit [pip.raspberrypi.com](http://pip.raspberrypi.com)

## Physical specification

### KSA-15E-051300HU

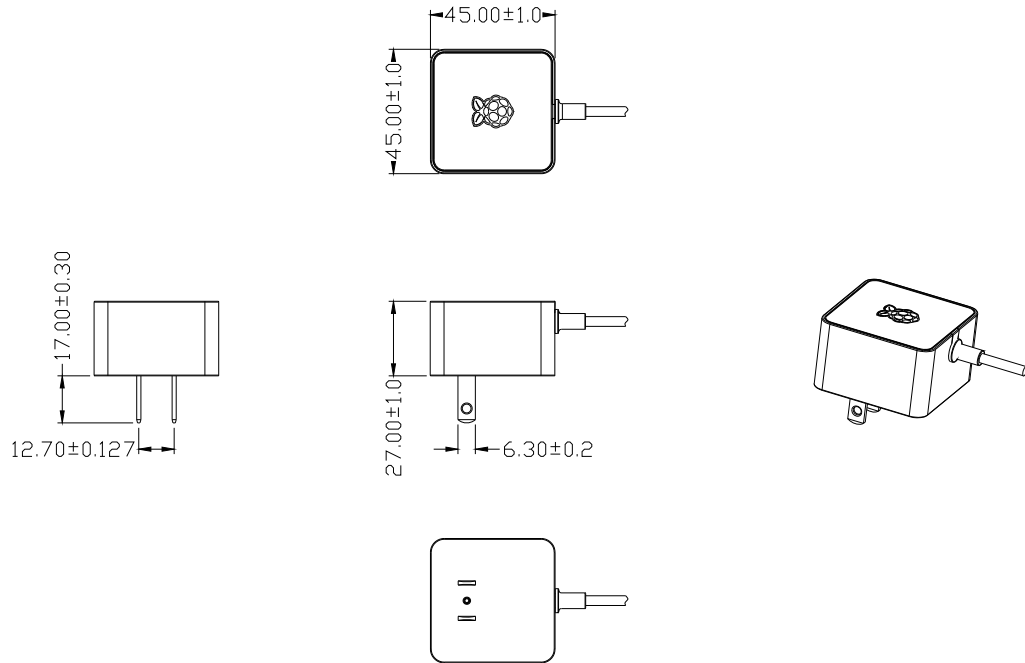

note: all dimensions in mm

### KSA-15E-051300HE

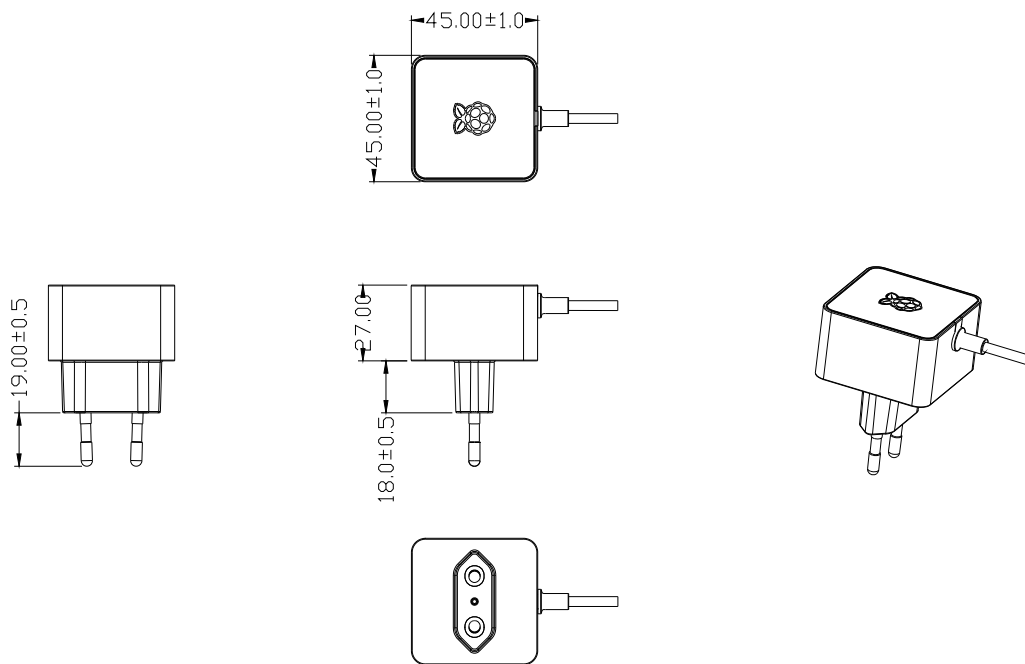

note: all dimensions in mm

### KSA-15E-051300HK

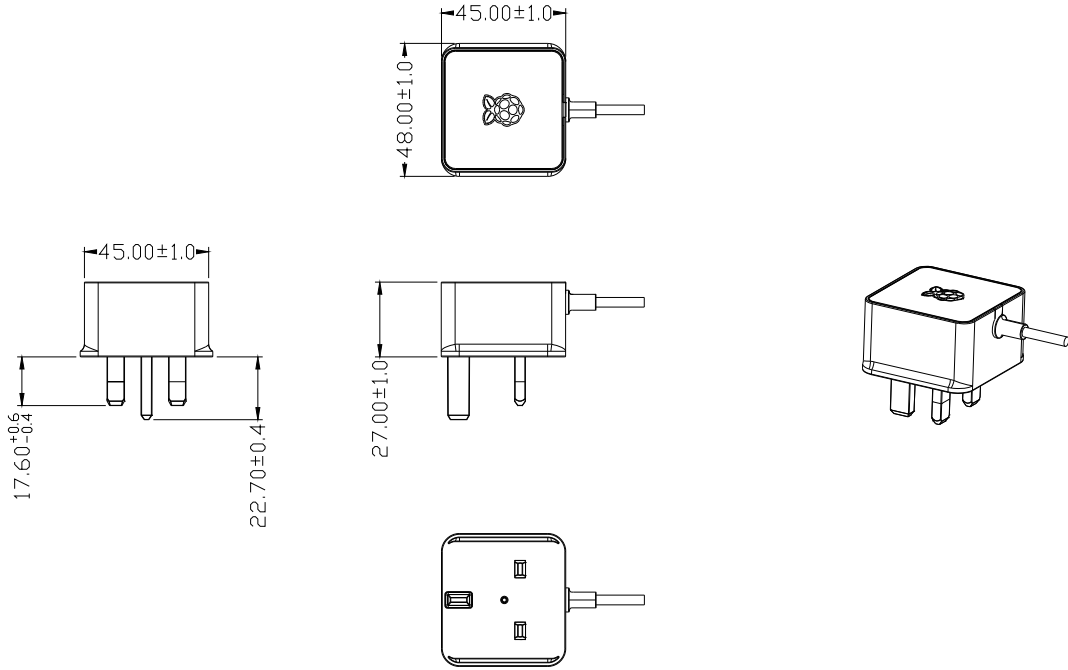

### KSA-15E-051300HA

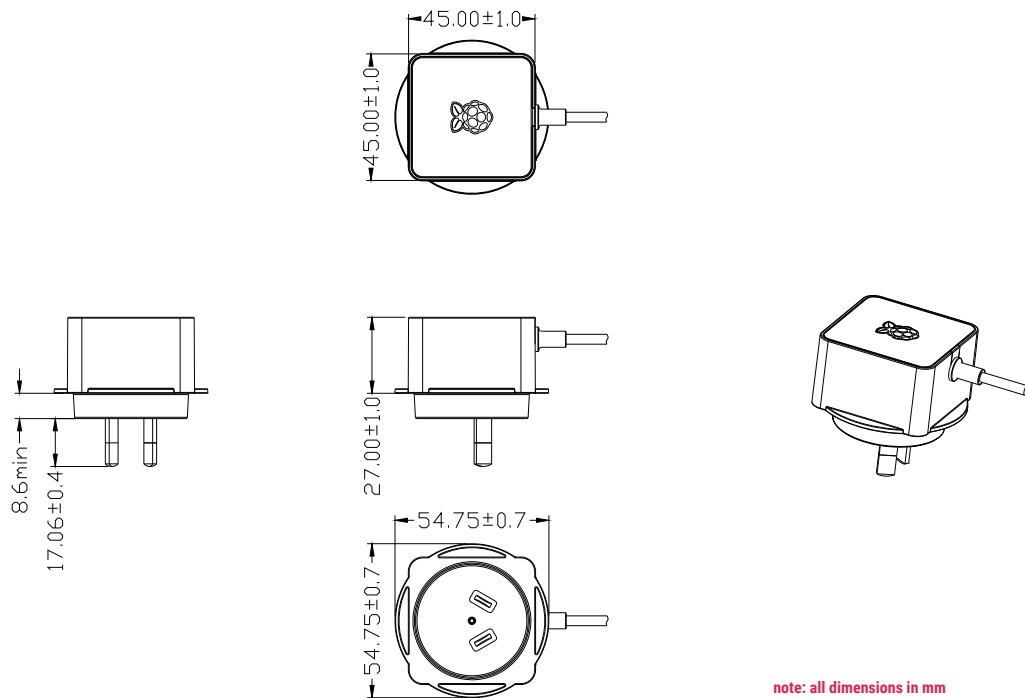

KSA-15E-051300HI

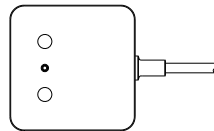
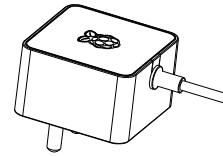
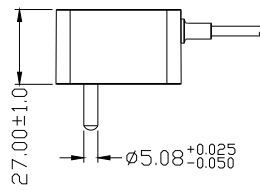
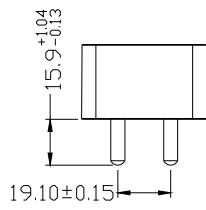
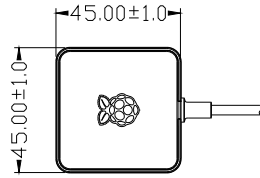

note: all dimensions in mm

## Case material

UL94V-1

## AC pin material

Brass (Ni-plated)

## DC cord and output plug

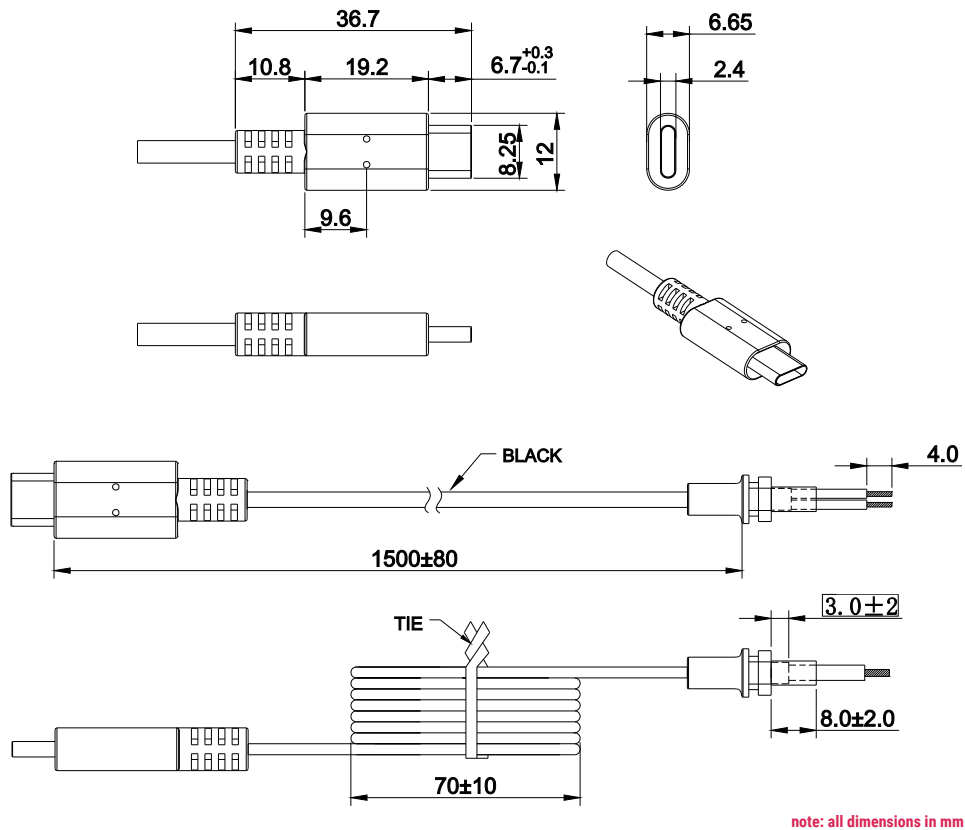

note: all dimensions in mm

## WARNINGS

- This product should be operated in a well-ventilated environment.
- The connection of incompatible devices to this power supply may affect compliance, result in damage to the unit and invalidate the warranty.

## SAFETY INSTRUCTIONS

To avoid malfunction or damage to this product please observe the following:

- Do not expose to water or moisture, or place on a conductive surface whilst in operation.
- Do not expose to heat from any source; this is designed for reliable operation at normal ambient room temperatures.
- Do not attempt to open or remove the power supply case.





Raspberry Pi is a trademark of Raspberry Pi (Trading) Ltd

---